

# SUBMITTING A PLAN FOR A STRUCTURE

## SLED NOTES

- ↓
- SHED HEIGHT IS 2.1m
- SHED AND OVERHANGS MORE THAN 30cm FROM BOUNDARY
- DOORS OPENS ONTO PLOT
- RAINWATER COLLECTED IN WATER BUTT (W)
- SHED IS RAISED 200mm ABOVE GROUND LEVEL ON BREEZE BLOCKS

The Committee finds it useful to see a sketch of any proposed structure. This is a guide to the information that should be included

HL 298  
BACK OF PLOT

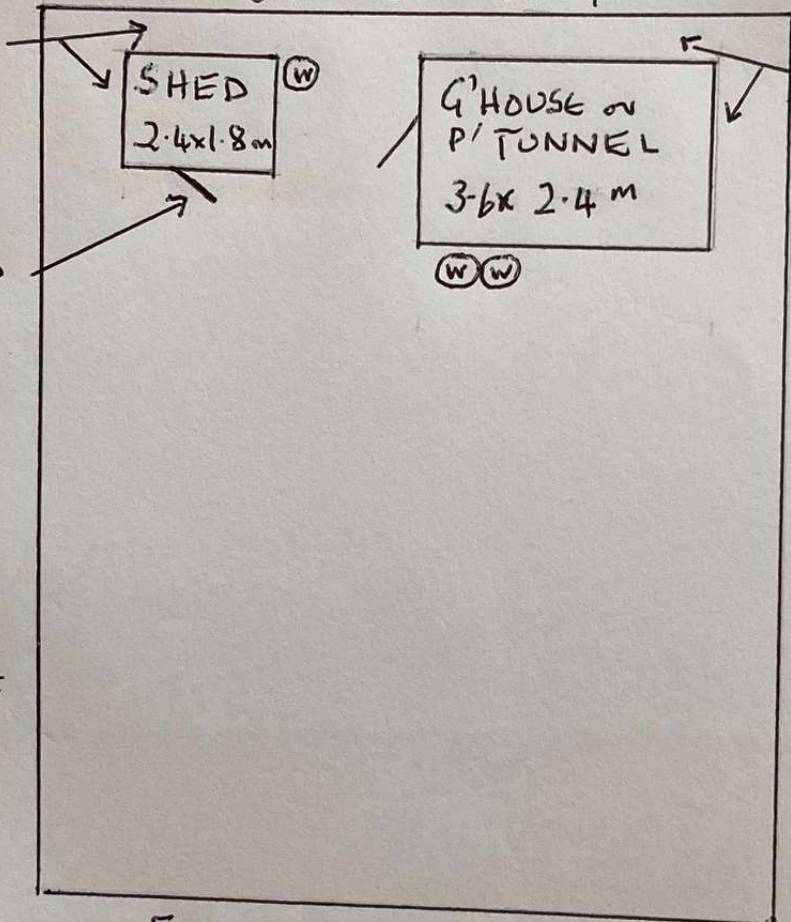

FRONT OF PLOT - ROADWAY

## POLYTUNNEL/ GREENHOUSE NOTES

- ↓
- DOOR OPENS ONTO PLOT
- P/G AND OVERHANGS MORE THAN 30cm FROM BOUNDARY
- G. GLASS IS TOUGHENED GLASS
- G. IS BOLTED DOWN ON 3x2 WOODEN BATTENS AND THESE ARE BOLTED TO CONCRETE BLOCKS
- P. COVER IS BURIED 30cm BELOW SURFACE TO ANCHOR IT DOWN
- RAINWATER COLLECTED IN WATER BUTTS (W)

## SHED, POLYTUNNEL & GREENHOUSE NOTES

- I HAVE DISCUSSED PLANS WITH MY NEIGHBOURS ON HL 297 + HL 299
- ALL MY STRUCTURES HAVE A TOTAL AREA OF LESS THAN 40% OF MY PLOT
- THERE ARE NO PERMANENT CONCRETE FOOTINGS